

ZÜRICH 822547918



A PROJECT BY



ILLUMINATING POSSIBILITIES



ILLUMINATING

FUTURES, EMPOWERING DREAMS

In the heart of RK Landmark, where the promise of success meets the lap of luxury, we invite you to envision a future that shines as bright as your dreams. Our premium office spaces are designed to be the launching pad of your ambitions. Join us at RK Landmark and let your journey be illuminated by endless possibilities.

SHINING THE LIGHT ON YOUR FUTURE

At RK Landmark, our commitment to illuminating the path to a brighter tomorrow is not only a concept, but also a striking feature of our architectural design that incorporates illuminating lights that not only enhance its visual appeal but also symbolize the journey of progress and success. As the sun sets and the lights come alive, RK Landmark transforms into a beacon of hope, where businesses flourish, dreams take flight, and a promising future awaits.



GROUND FLOOR LAYOUT

45.00 MT. WIDEROAD

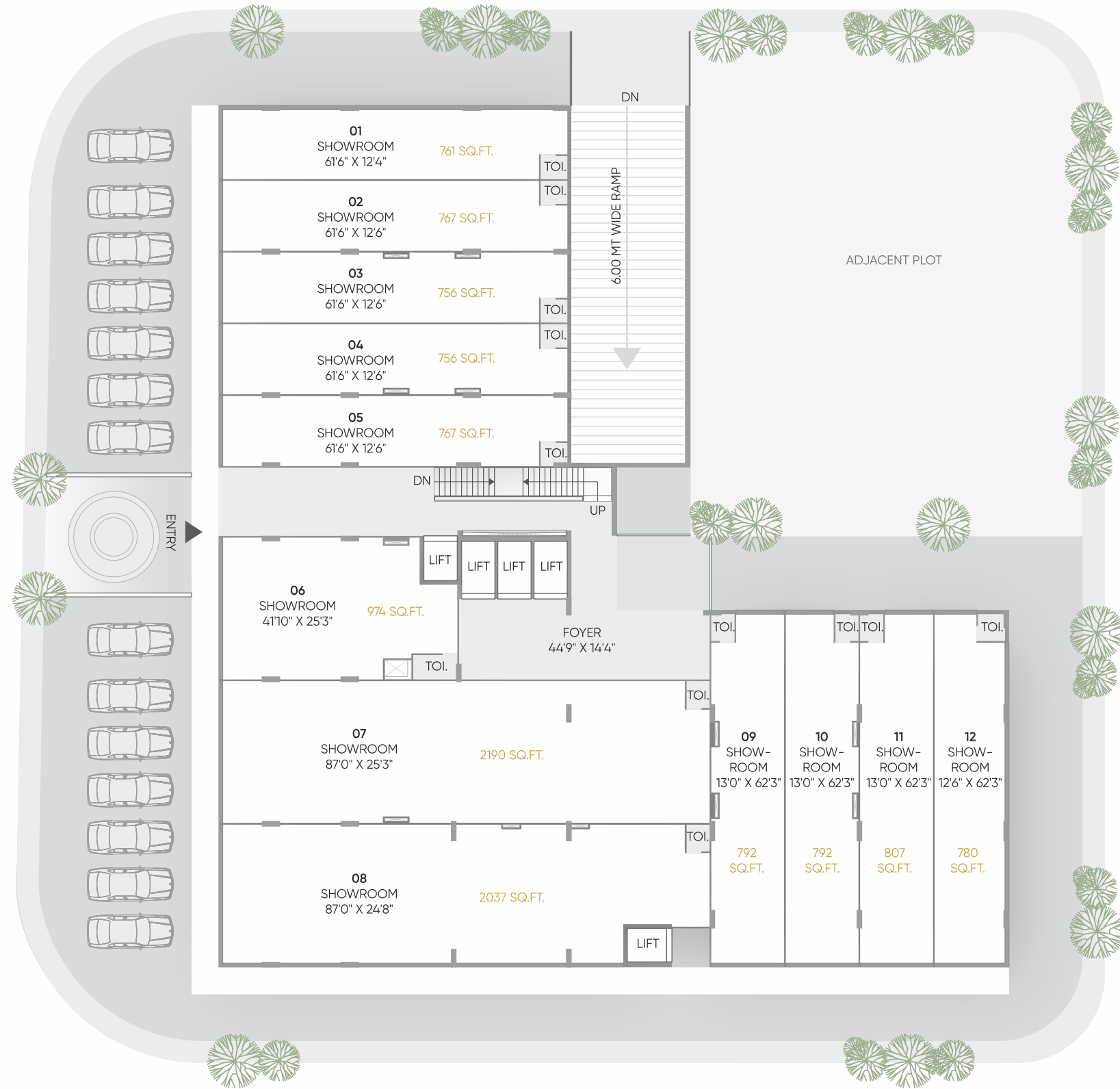

9.15 MT. WIDEROAD

1ST&2ND FLOOR LAYOUT

45.00 MT. WIDEROAD

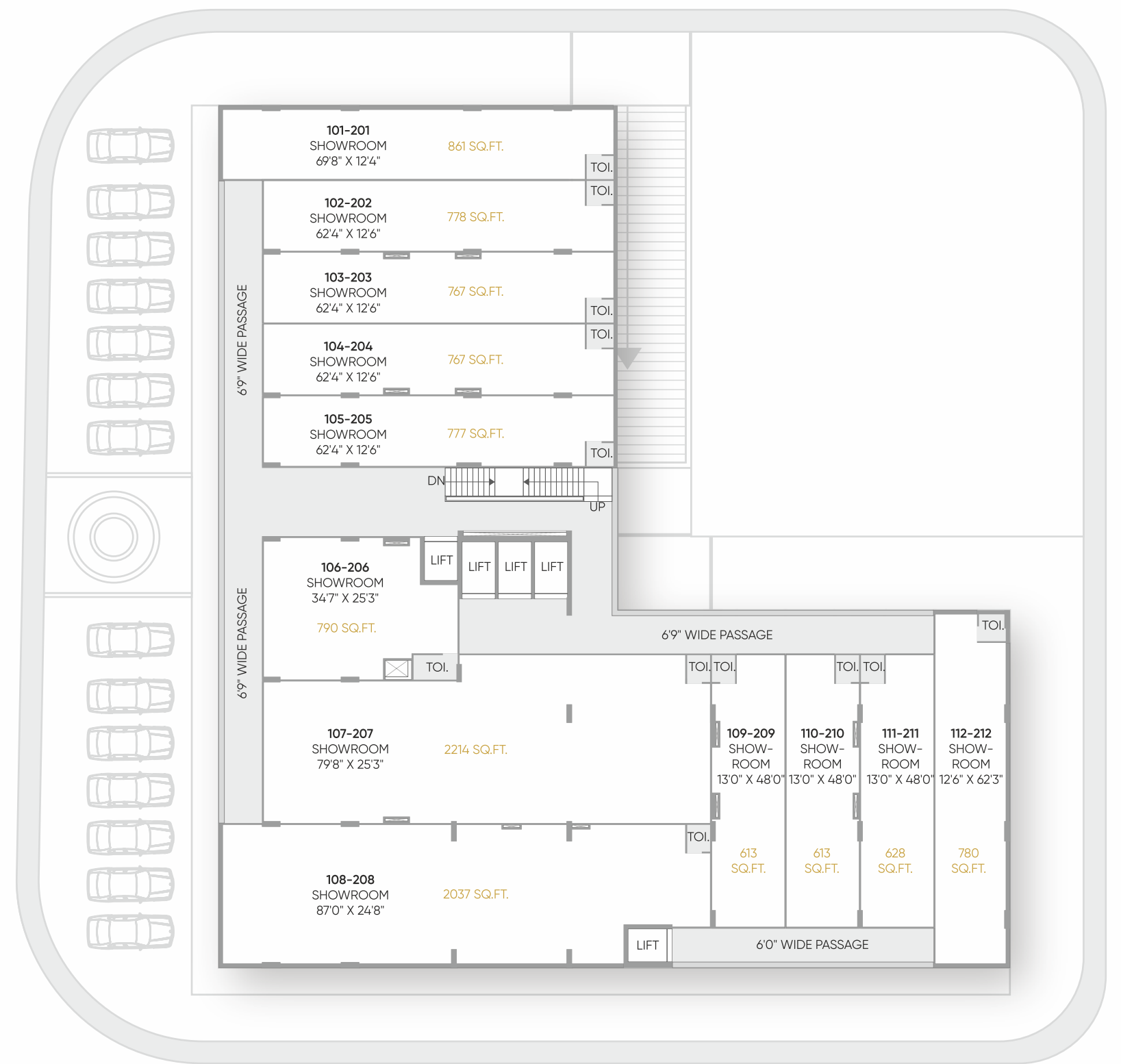

9.15 MT. WIDEROAD

TYPICAL
FLOOR LAYOUT
3RD TO 7TH FLOOR



7.50 MT. WIDER ROAD

45.00 MT. WIDER ROAD

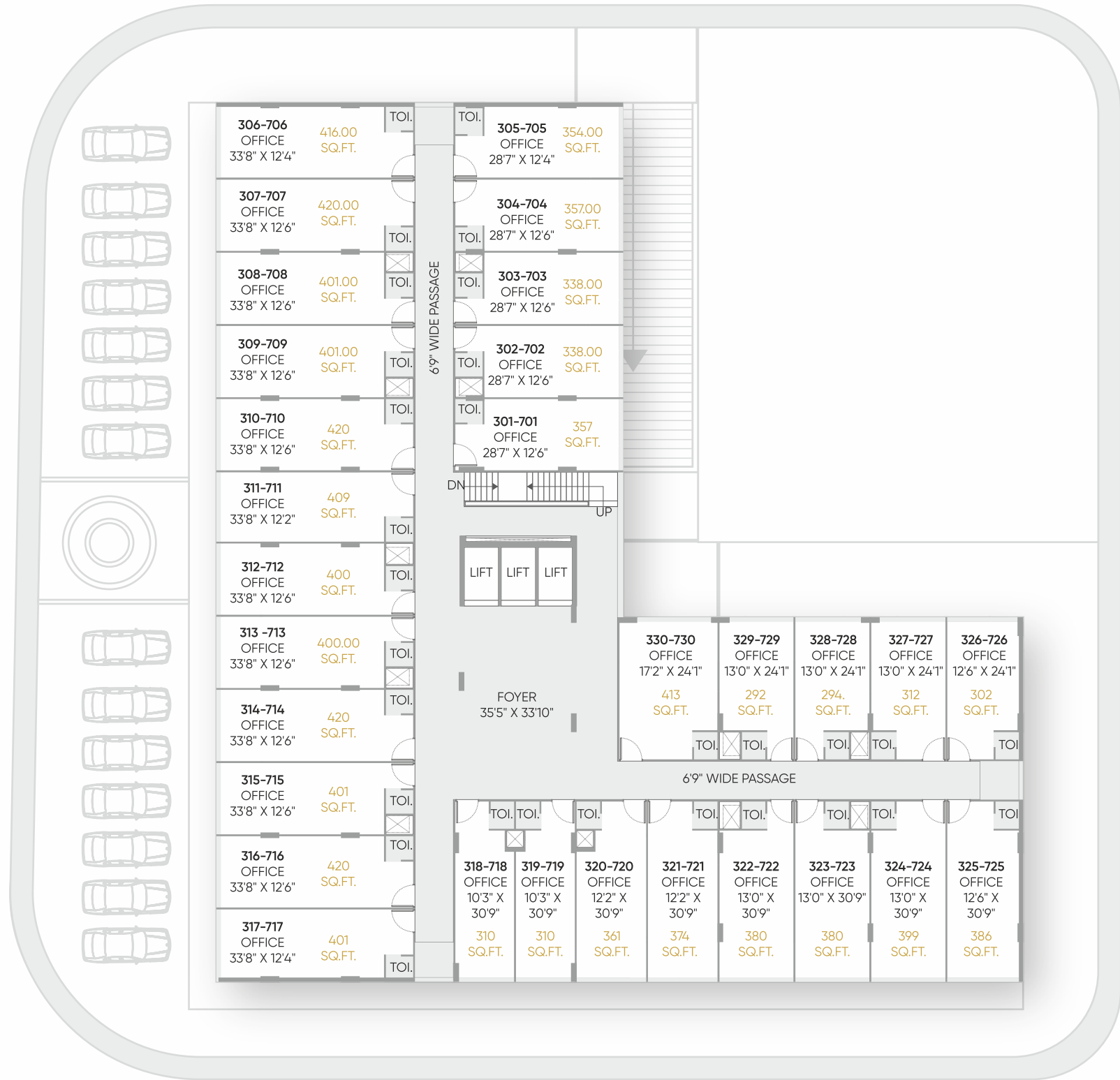

9.15 MT. WIDER ROAD

Take a look at the genius layout of RK Landmark, where each element is strategically designed to help your business to reach to the new heights. With two spacious basement levels for ample parking, accessibility is a breeze. Our thoughtfully planned distribution of showrooms, shops, and offices offers you the perfect space to match your business needs. Additionally the four sided road access provides prime visibility and east entry from multiple directions. Join us on this journey, where the blueprint for prosperity begins.

**THE
BLUEPRINT
OF
SUCCESS**

9.15 MT. WIDER ROAD

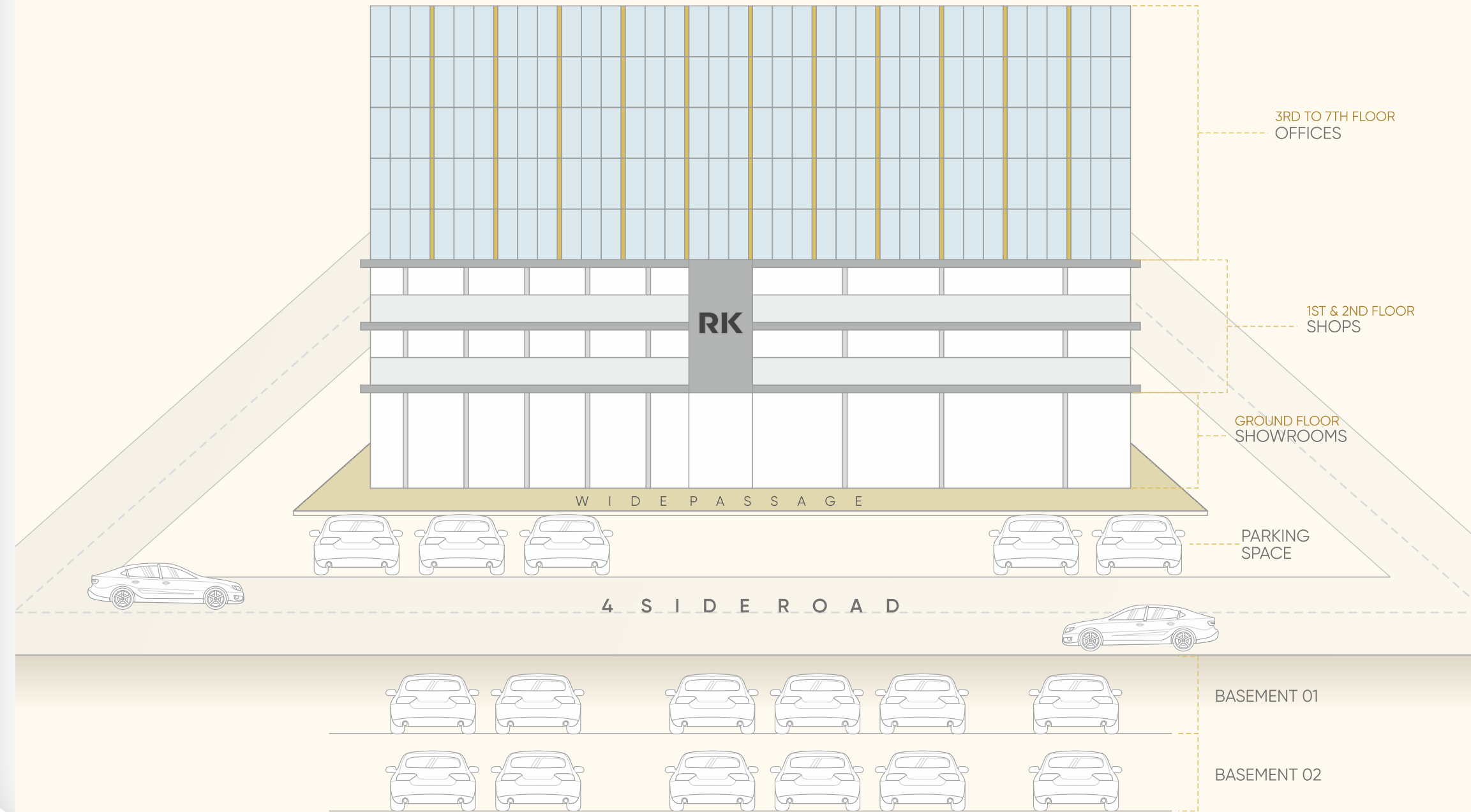

BASEMENT 01

BASEMENT 02



Developers:



Site Address :

RK Landmark Opp Fortune Hotel,
Nr Mavdi Chowk, 150 Feet Ring Road, Rajkot-360004 .

+91 74900 18000

gaurav@rkrealty.in | www.rkrealty.in

Architect

MANSI SHAH ARCHITECTS
AHMEDABAD

Structure

MANISH DOSHI
RAJKOT

MEP Consultant

Artech Engineers
AHMEDABAD

LEGAL DISCLAIMER: * All furniture / objects shown in the plan are for presentation & understanding purpose only. By no means, it will form a part of final deliverable product.# All the elements, objects, treatments, materials, equipment & color scheme are artisan's impression & purely for presentation purpose. By no means it will form a part of the amenities, features or specification of our final product.

NOTE: All rights for alteration / modification & development in design or specifications by architects & / or developer shall be binding to all the members. - Completion Certificate as per RMC rules, clear title document will be provide by promoters for loan purpose. This brochure is for private circulation only. By no means it will form part of any legal contract.

· Stamp duty, Registration charges, Legal charges, PGVCL charges, Society maintenance deposit etc. shall be borne by the purchaser. · VAT, Service Tax, TDS, TCS, GST & or any other taxes levied in future will be Borne by the purchaser as applicable. · Any additional charges or duties levied by the Government / Local Authorities during or after completion of the scheme shall be borne by the purchaser. · In the interest of continual developments in design & quality of construction, the developer reserves all rights to make any changes in the scheme including and not limited to technical specifications, design, planning, layout & all purchasers shall abide by such changes. Changes/alteration of any nature including elevation, exterior color scheme, balcony grill or any other changes affecting the overall design concept & outlook of the scheme are strictly NOT PERMITTED during or after the completion of the scheme. · Any RCC member (Beam, Column, Slab) must not be damaged during your interior work. · Low-voltage cables such as telephone, TV and internet cables shall be strictly laid as per consultant's service drawings with prior consent of Developer / Builder's office. No wire/cables/conduits units shall be laid or installed such that they form hanging formation on the building exterior faces. · Common passages / landscaped areas are not allowed to be used for personal purpose. · Subject to Rajkot jurisdiction